



Steel Structure WorkShop 1



Steel Structure WorkShop 2

Steel Structure Workshop :

Steel Structure Workshop:

Characteristics of [steel structure workshop](#):

- 1.Environmentally Friendly
- 2.Easy to Maintain with Low Cost
- 2.Stable under up to 9 Grade Earthquake Resistance
- 3.Less Time and Labor Needed for Fixing
- 4.Good Appearance

Reference Price of Steel Structure Workshop:

Reference Prcie					
Span	Distance of Column	Height of Eave	Crane	Wall & Roof	Reference Price
24m	6m	8m	One set single beamCrane, Span: 22.5m, A5 Work force	Single Colour sheet	62~68\$USD/m ²
				Single colour sheet with glass wool	69~75\$USD/m ²
				EPS Sandwich	78~84\$USD/m ²

				panel	
--	--	--	--	-------	--

Note:The above price is only for reference. Particular prices for particular products would be quoted after professional design and calculation.



Structural Drawing

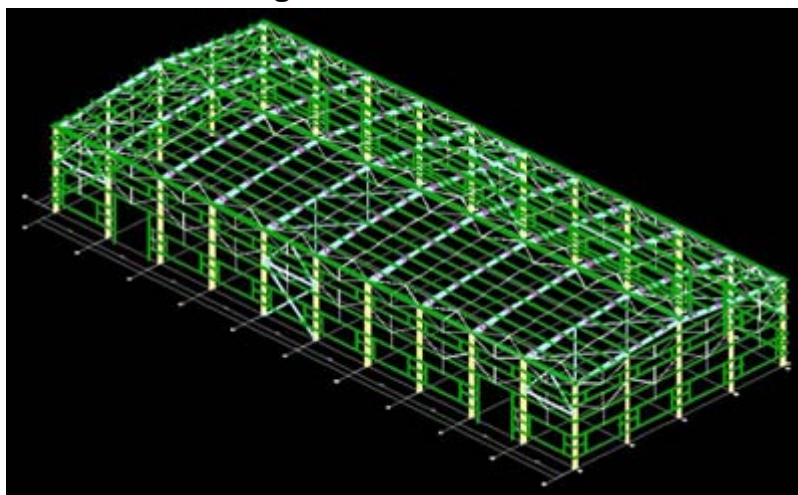

Steel Structure Workshop:

1. Main Structure: Steel Welded H Section
2. Purlin: C Section Channel or Z Section Channel
3. Roof Cladding: Sandwich Panel or Corrugated Steel Sheet with Fiber Glass Wool Coil
4. Wall Cladding: Sandwich Panel or Corrugated Steel Sheet
5. Tie Rod: Circular Steel Tube
6. Brace: Round Bar

7. Column and Beam: Welding H section steel
8. Knee Brace: Angle Steel
9. Wrapping Cover: Color Steel Sheet
10. Roof Gutter: Color Steel Sheet
11. Crane: With one set 5ton Single-Beam Crane, Span of Crane:22.5m, Grade: A5
12. Wall and Roof insulation: Single colour sheet, Colour sheet with Glass-wool, EPS Sandwich panel
13. Rainspout: PVC Pipe
14. Sliding Sandwich Panel Door or Metal Door
15. Door: Sliding Door, use 50mm EPS Sandwich panel
16. Window: Aluminum Window .
17. Connecting: High Strength Bolts

Relevant pictures:



[Steel Building with Large Span, Low Demands of Base Structure, Strong Seismic and Wind Resistance](#)

Model Number: [Steel Structure Building](#)

Key Specifications/Special Features:

Fast construction: time-saving, labor-saving, easy installation

Insulation panel: EPS, XPS, rock wool, PU sandwich

Surface treatment: anti-rust paint with 2 layers

Good quakeproof: 9 grade

Door and window: various types of PVC, ALU profile
Environment-friendly: no rubbish, to be green building
Overhead crane: afford 80T crane inside
Storey: 1 or 2
Design: Chinese standard
ISO 9001:2008-certified
Shipment: by top open container
Wide span: single or multiple spans, maximum span is 36m without middle column
Long lifespan, up to 50 years
Others: environment-friendly, stable structure, earthquake resistance, waterproofing and energy-saving

Materials:

The main frame (columns and beams) is made of welded H-style steel
The columns are connected with the foundation by pre-embedding anchor bolt
The beams and columns, beams and beams are connected with high intensity bolts
The envelop construction net is made of cold form C-style purlins

Country of Origin:

China (mainland)

Brand Name: Dongying Wanlong

Primary Competitive Advantages:

Country of Origin
Experienced Staff
Packaging
Price
Product Features
Product Performance
Quality Approvals
Reputation
Service
Small Orders Accepted

Main Export Markets:

Eastern Europe
North America
Mid East/Africa
Central/South America
Asia

Western Europe
Australasia

Payment Details:

Payment Terms:
Telegraphic Transfer in Advance (Advance TT, T/T)

Minimum Order:

1 to 99 Unit

Delivery Details:

FOB Port:

Qingdao

Lead Time:

25 - 30 days